



» nandana »

lord shiva's son

plot no.21, sector 17, roadpali

typical floor plan (1st to 4th floor)

←----- 11 m wide road ----->

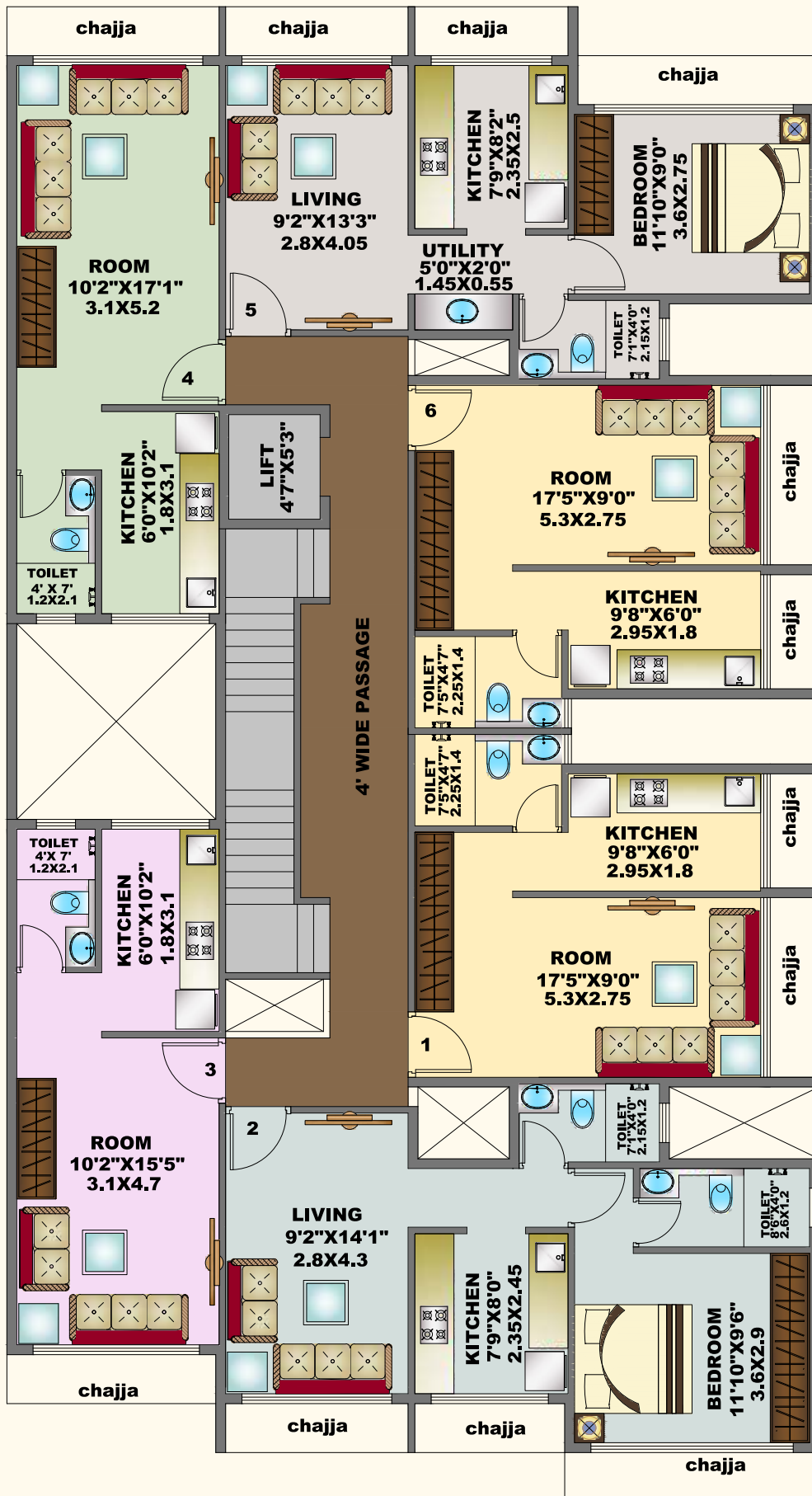

project features

clear title CIDCO plot

stilt + 4 storied building with 1 Rk & 1 Bhk flats

earthquake resistant RCC structure

CCTV surveillance for entrance lobby

sufficient underground & overhead tanks for water supply

intercom facility in all flats

elevator of reputed make

project amenities

living & bedrooms

2' x 2' vitrified flooring | gypsum finished walls in rooms

kitchen

2' x 2' vitrified flooring | granite platform with stainless steel sink | tiles upto 2 feet height above platform

bathrooms & toilets

concealed plumbing with hot & cold diverter arrangement of reputed make | good quality sanitary fittings Cera / Jaguar or equivalent make | antiskid flooring | full height glazed tiles | geyser in bathroom

doors & windows

decorative laminated solid flush doors for main door & bedroom doors | FRP / PVC doors for bathroom & toilet
anodized aluminium sliding windows

electrical fittings

leGrand or equivalent make switch boards & switches | points for lighting, telephone, TV, aquaguard, refrigerator & exhaust fan will be provided | provision for internet connectivity at distribution board of flat

painting

all internal walls with emulsion paint and external walls with acrylic paint

location map

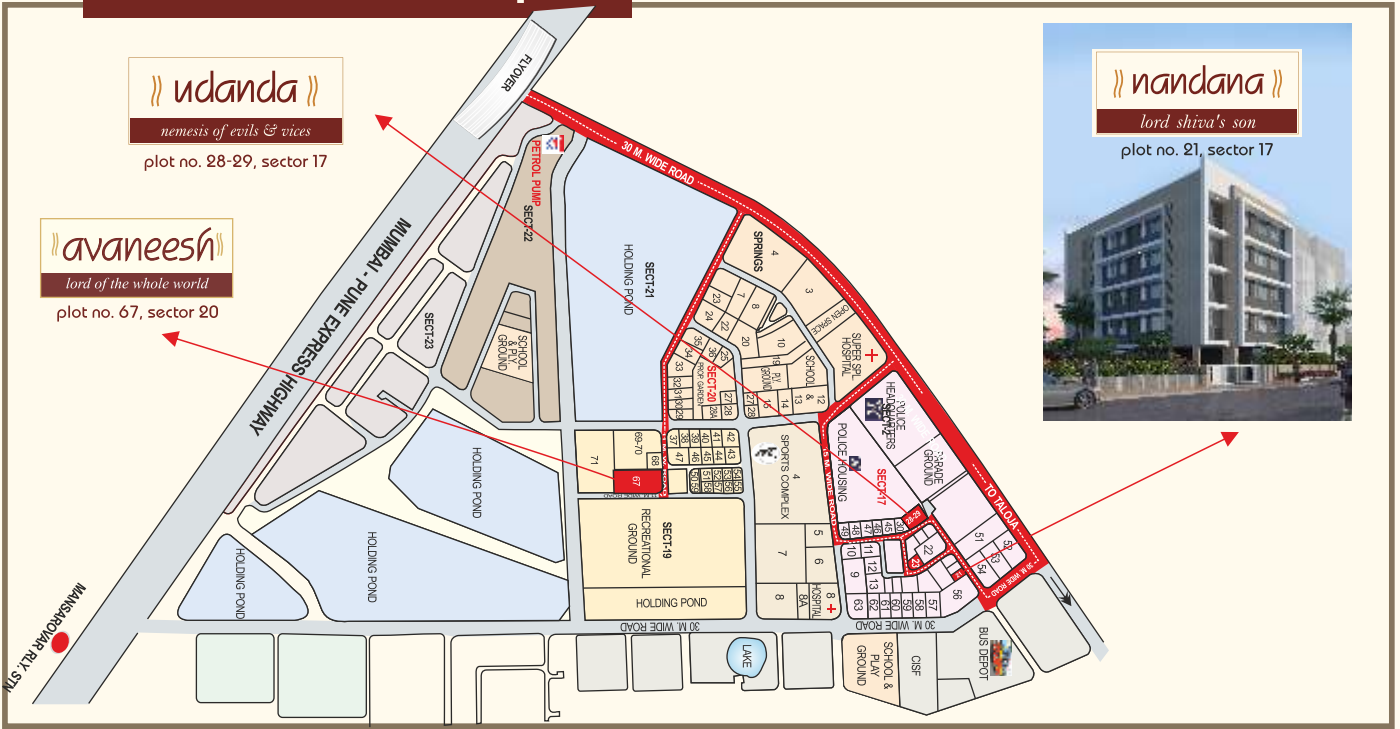

the location advantage

- 5 minutes drive to mumbai-pune express highway
- 10 minutes drive to kharghar railway station
- 10 minutes drive to mansarovar railway station
- 10 minutes drive to central park, iskon temple, golf course and amusement park
- proposed international airport is approximately 7kms. from project
- opposite central bus depot & near proposed metro station
- hospital, banks, atm's, shopping zones & other functional civic facilities in close vicinity
- renowned educational institutes in close proximity



project by :

Sai Developers

MahaRERA registration no.

P52000018181

maharera.mahaonline.gov.in

architect : soʏuz talib

rcc consultant : structural concepts

corporate office : S-23, ashiana, sector-17, vashi, navi mumbai - 400 703

www.saidevelopersgroup.com | email: saideveloper@vsnl.net

booking contact : 022 2789 1805, 2789 1969, 2789 5134

DISCLAIMER: THE PREVIEWED IMAGES IN THE BROCHURE ARE INDICATIVE BASED ON THE CONSTRUCTION OF THE BUILDING AS IS PROPOSED AT PRESENT AND IT IS ISSUED IN GOOD FAITH SUBJECT TO THE APPROVAL OF THE AUTHORITIES OR IN THE INTEREST OF THE CONTINUING IMPROVEMENT AND DEVELOPMENT OF THE BUILDING. THE DEVELOPERS RESERVE THE RIGHT TO ALTER THE LAYOUT, PLANS, SPECIFICATIONS OR FEATURES WITHOUT PRIOR NOTICE OR OBLIGATION AS PER APPROVED PLAN. THE DETAILS AND IMAGES CONTAINED IN THE BROCHURE OR ANY OTHER PRINTED MATERIAL ARE ONLY INDICATIVE AND ARTISTIC IMAGINATION MAY NOT BE EXACT OR ACCURATE AND THE SAME DO NOT FORM EITHER THE BASIC OR PART OF THE OFFER OR CONTRACT OR AGREEMENT.