

» gaurisuta »

*the son of gauri*

survey no.743/1,panvel



## the specification

### living & bedrooms

2' x 2' vitrified flooring | gypsum finished walls in rooms

### kitchen

2' x 2' vitrified flooring | granite platform with stainless steel sink | tiles upto 2 feet height above platform

### bathrooms & toilets

concealed plumbing with hot & cold diverter arrangement of reputed make | good quality sanitary fittings of cera / jaquar or equivalent make | antiskid flooring | full height glazed tiles | geysers in bathroom

### doors & windows

decorative laminated solid flush doors for main door & bedroom doors | FRP / PVC doors for bathroom & toilet | anodized aluminium sliding windows

### electrical fittings

leGrand or equivalent make switch boards & switches | points for lighting, telephone, TV, aquaguard, refrigerator & exhaust fan will be provided | provision for internet connectivity at distribution board of flat

### painting

all internal walls with emulsion paint and external walls with acrylic paint



1<sup>st</sup>, 3<sup>rd</sup>, 5<sup>th</sup> & 7<sup>th</sup> floor plan

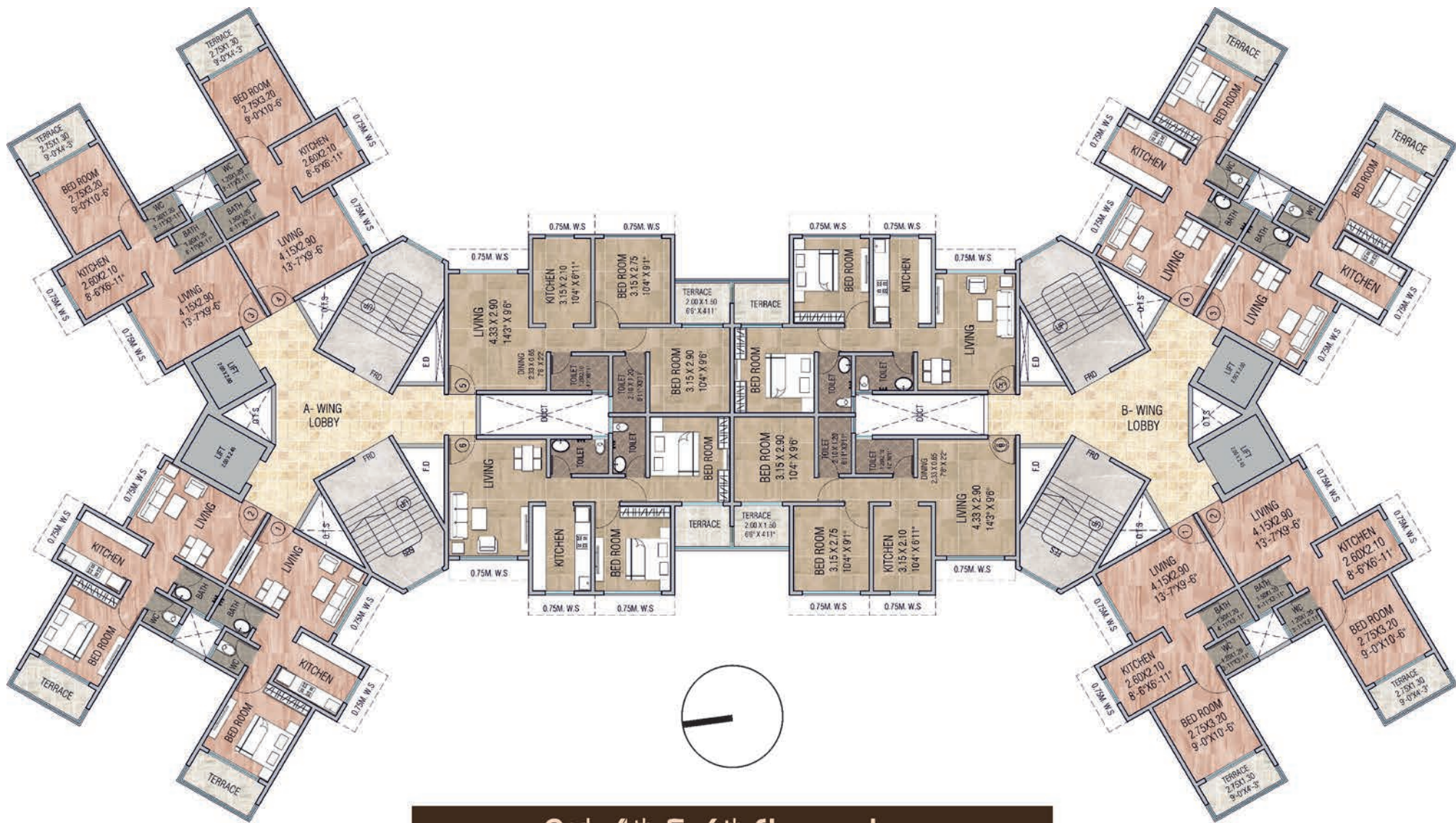

2<sup>nd</sup>, 4<sup>th</sup> & 6<sup>th</sup> floor plan



8<sup>th</sup> floor plan



9<sup>th</sup> floor plan

## project highlights



clear title plot



9 storied Building  
with 1 Bhk & 2 Bhk flats



earthquake resistant  
RCC structure



timely possession  
& superior quality



intercom facility  
in all flats



elevator of  
reputed make



CCTV surveillance for  
entrance lobby



sufficient underground  
& overhead tanks  
for water supply



gymnasium



security cabin at  
the entrance gate



power backup facility  
for lift, staircase,  
water pumps  
& common area

## location map



## location advantage

- 10 mins drive from panvel station
- 3 km distance from proposed international airport
- in proximity of reputed schools, engineering & medical colleges, multiplexes, malls, banks, super specialty hospitals, educational institutes within the radius of 2 kms
- 20 minutes drive from central park, kharghar
- well-connected by national highways and expressways
- well-connected to business district and SEZ's



project by :

**Sai Developers**

MahaRERA registration no.  
**P52000018222**  
maharera.mahaonline.gov.in

architect : O7 architects and planners

rcc consultant : c.s.e. consultants

corporate office : S-23, ashiana, sector-17, vashi, navi mumbai - 400 703

www.saidevelopersgroup.com | email: saideveloper@vsnl.net

booking contact : 022 2789 1805, 2789 1969, 2789 5134

**DISCLAIMER:** THE PREVIEWED IMAGES IN THE BROCHURE ARE INDICATIVE BASED ON THE CONSTRUCTION OF THE BUILDING AS IS PROPOSED AT PRESENT AND IT IS ISSUED IN GOOD FAITH, SUBJECT TO THE APPROVAL OF THE AUTHORITIES OR IN THE INTEREST OF THE CONTINUING IMPROVEMENT AND DEVELOPMENT OF THE BUILDING. THE PROMOTERS DEVELOPERS RESERVE THE RIGHT TO ALTER THE LAYOUT, PLANS, SPECIFICATIONS OR FEATURES WITHOUT PRIOR NOTICE OR OBLIGATION AS PER APPROVED PLAN. THE DETAILS AND IMAGES CONTAINED IN THE BROCHURE OR ANY OTHER PRINTED MATERIAL ARE ONLY INDICATIVE AND ARTISTIC IMAGINATION MAY NOT BE EXACT OR ACCURATE AND THE SAME DO NOT FORM EITHER THE BASIC OR PART OF THE OFFER OR CONTRACT OR AGREEMENT.